

Your Source For:



Magnum 501

DESCRIPTION

Undercounter Double Bowl
 Overall Size: 32" x 17-3/4", 8"(L) 7"(R) Deep
 810 mm x 450mm, 200mm (L), 178mm(R)
 Deep

FEATURES

304 stainless steel 18 guage. Small bowl on the right
 StoneGuard Undercoated over rubber pad.
 Offset drain, 3-1/2" (114 mm) drain opening



FINISH

Brushed Satin Finish

INSTALLATION

Undercounter installation
 Supplied with cut-out template, fasteners

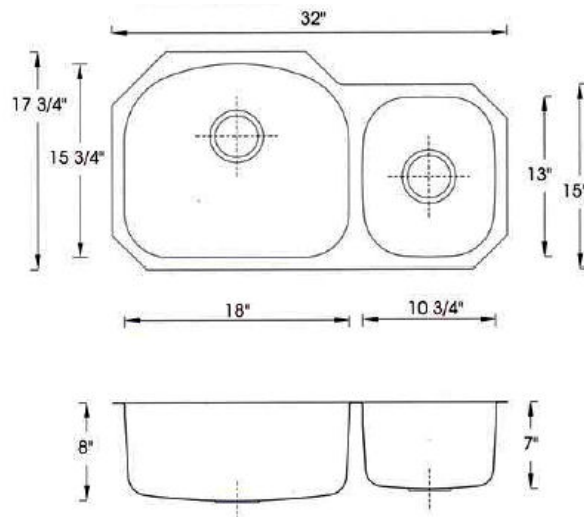

SINK DIMENSIONS

Item No.	Overall Dimension	Each Bowl	Cutout Size	Gauge	Weight/Lbs
501	32" x 17-3/4" 810 mm x 450mm	18" x 15-3/4" 13" x 10-3/4"	See template	18 Gauge	11.5

X:\forms\magnum501.doc

5760 Quam Avenue N.E. • St. Michael, MN 55376 • Phone: (763) 428-4075 • Fax: (763) 428-1795
 www.paramountgranite.com • E-Mail: info@paramountgranite.com

